

Data Sheet



Article number: 20054552

Description: E+G Quick-fit coupling (radial displacement)
GN 240-M10x1,25-A

Measures

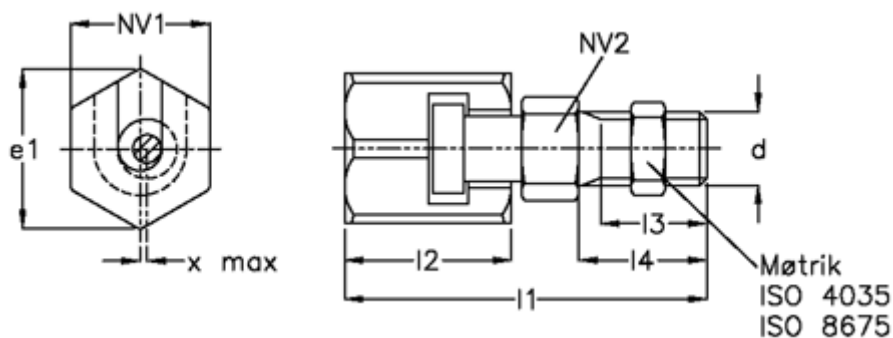

d	= M 10x1,25	NV 1 = 27
e1	= 30.0	NV 2 = 17
l1	= 56.0	
l2	= 29.0	
l3	= 16.0	
l4	= 20	
Max displacement	= 0.7	
Max push-pull strength N	= 6500	